

GENERAL NOTES

- CONTRACTOR IS REQUIRED TO VERIFY FIELD CONDITIONS AND NOTIFY ENGINEER OF ANY DISCREPANCIES PRIOR TO START OF WORK.
- THE LOCATION OF UTILITIES SHOWN ARE APPROXIMATE. CONTRACTOR SHALL COORDINATE EXACT UTILITY LOCATIONS WITH THE LOCAL UTILITY COMPANIES PRIOR TO COMMENCING ANY WORK. CONTACT THE INDIANA UNDERGROUND PLANT PROTECTION SERVICES, INC. AT 1-800-382-5544.
- CONTRACTOR SHALL INSTALL TEMPORARY EROSION CONTROL MEASURES PRIOR TO START OF WORK TO ENSURE SEDIMENT DOES NOT LEAVE THE SITE.
- THIS PLAN SHOWS THE OVERALL AREAS OF DEMOLITION TO ALLOW CONSTRUCTION OF IMPROVEMENTS. THE EXACT AREAS OF DEMOLITION SHALL BE ESTABLISHED AND RESTORED BY THE CONTRACTOR. CONTRACTOR SHALL REMOVE ALL DEMOLISHED MATERIAL FROM THE SITE UNLESS NOTED OTHERWISE.
- REMOVE EXISTING STRUCTURES, ASPHALT, CONCRETE, GRAVEL, SOIL, LANDSCAPING AND OTHER MATERIALS AS REQUIRED TO CONSTRUCT DESIGNED IMPROVEMENTS UNLESS NOTED OTHERWISE.
- CONTRACTOR SHALL SAW CUT ALONG PAVEMENTS AND OTHER ADJOINING SURFACES TO REMAIN. SIDEWALKS AND CURBS SHALL BE REMOVED TO THE NEXT CLOSEST JOINT BEYOND.
- AREAS DISTURBED DURING DEMOLITION, CONSTRUCTION, AND GRADING ACTIVITIES SHALL BE RESTORED TO PRE-EXISTING CONDITIONS OR BETTER, UNLESS NOTED OTHERWISE.
- THE CONTRACTOR SHALL BE RESPONSIBLE FOR ALL DEMOLITION WORK NECESSARY IN ORDER TO COMPLETE THE PROJECT AS DESIGNED.
- CONTRACTOR TO PROTECT ALL EXISTING VEGETATION NOT SCHEDULED FOR REMOVAL. REFER TO SHEET 1000 FOR TREE PRESERVATION PLAN.

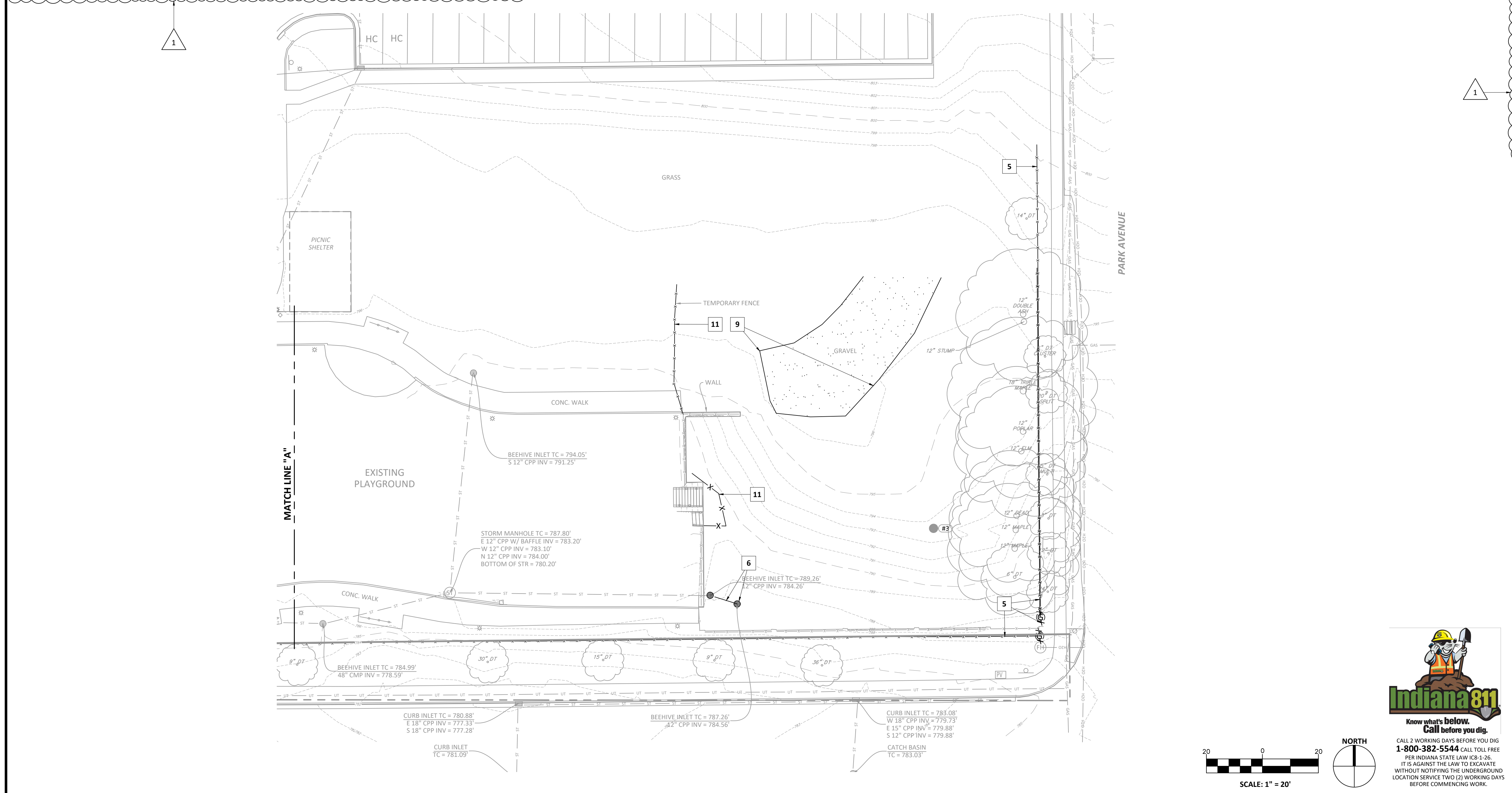

PLAN NOTES

- REMOVE EXISTING ASPHALT PAVING.
- REMOVE EXISTING CONCRETE PAVEMENT AND/OR STEPS
- REMOVE EXISTING CONCRETE CURB
- REMOVE CONCRETE RETAINING WALL AND FENCE/GUARDRAIL
- REMOVE EXISTING CHAIN LINK FENCE.
- REMOVE EXISTING STORM INLET AND PIPING
- REMOVE EXISTING HANDRAIL/GUARDRAIL
- REMOVE EXISTING TREE
- REMOVE EXISTING GRAVEL
- EXISTING RETAINING WALL TO REMAIN
- EXISTING TEMPORARY FENCING - TO BE REMOVED BY OWNER

LEGEND

▲ YARD LIGHT	— FENCE	○ FD AXEL
○ LIGHT POLE	— GUARDRAIL	○ FD BRASS DISK
⊙ SIGNAL POLE	— OVERHEAD WIRES	○ FD COT GIN SPDLE
⊙ UTILITY POLE	— UNDER ELEC.	○ FD CHISELED X
⊙ GUY WIRE	— GAS LINE	○ SET CHISELED X
⊙ CATCH BASIN	— SAN SEWER LINE	○ SET DRILL HOLE
⊙ CURB INLET	— ST — STORM SEWER LINE	○ FD HARRISON MON.
⊙ ELECTRIC MH	— UT — UNDER TELEPHONE	○ SET HARRISON MON.
⊙ MANHOLE	— H2O — EXISTING WATER LINE	○ SET HUB/TACK
⊙ PHONE MH	— CHILLED WATER LINE	○ FD REBAR
⊙ SANITARY MH	— SIGN	○ SET REBAR
⊙ SIGNAL MH	— R.O.W. MON.	○ FD MAG NAIL
⊙ STEAM MH	— MONITORING WELL	○ SET MAG NAIL
⊙ P.MTR	— BOLLARD	○ FD NAIL
⊙ SPIGOT	— BORE HOLE	○ SET NAIL
⊙ T-POST	— DOWNSPOUT	○ FD PIPE
⊙ WOOD POST	— GATE POST	○ FD RR SPIKE
⊙ PARKING SPACES	— POLE	○ SET RR SPIKE
⊙ TRANSFORMER	— PARKING METER	○ FD STONE
⊙ ELEC. VAULT	— WOOD POST	○ (R) RECORDED B&D
⊙ PHONE VAULT	— PARKING SPACES	○ (M) MEASURED B&D
⊙ VALVE VAULT	— TRANSFORMER	○ (C) CALCULATED B&D
⊙ AC UNIT	— ELEC. VAULT	○ (PROP) PROPORTIONAL DIST.
⊙ MAILBOX	— PHONE VAULT	○ A.G. ABOVE GROUND
⊙ BIRD FEEDER	— VALVE VAULT	○ B.G. BELOW GROUND
⊙ PROP. TANK	— AC UNIT	○ CONIF. TREE
⊙ PARKING BLOCK	— PHONE BOOTH	○ DECID. TREE
	— BIRD FEEDER	○ SHRUB
	— MAILBOX	○ PHONE RISER-BOX
	— PROP. TANK	○ TV RISER-BOX
	— PARKING BLOCK	○ ELEC. RISER-BOX
		○ GAS RISER-BOX

UTILITY CONTACTS

AT&T
Rusty Owens - (765) 341-0201

DUKE ENERGY
Rob Sanders - (812) 668-0490

CITY OF BLOOMINGTON UTILITIES (CBU)
Nancy Asosm - (812) 349-3689

CENTERPOINT
Timmy Langston - (812) 348-6703

COMCAST
Steve McArtor - (812) 366-3090

SMITHVILLE
Mason Bohall - (812) -935-2267

Revision	Date	Description
1	2025-02-07	ADDENDUM 1

DATE: 2025/01/27
PROJECT NO: 23-1547
DRAWN BY: DLN
CHECKED BY: AEK

These Drawings and Specifications, and all copies thereof are and shall remain the property and copyright of the Landscape Architect. They shall be used only with respect to this Project and are not to be used on any other Project or Work without prior written permission from the Landscape Architect.

Know what's below. Call before you dig. 1-800-382-5544 CALL TOLL FREE PER INDIANA STATE LAW ICB-3-26. IT IS AGAINST THE LAW TO EXCAVATE WITHOUT NOTIFYING THE UNDERGROUND LOCATION SERVICE TWO (2) WORKING DAYS BEFORE COMMENCING WORK.

Know what's below. Call before you dig. 1-800-382-5544 CALL TOLL FREE PER INDIANA STATE LAW ICB-3-26. IT IS AGAINST THE LAW TO EXCAVATE WITHOUT NOTIFYING THE UNDERGROUND LOCATION SERVICE TWO (2) WORKING DAYS BEFORE COMMENCING WORK.

context DESIGN

5825 Lawton Loop E. Dr. | Indianapolis, IN 46216
317-485-6900 | www.context-design.com

BRCJ

Indiana Registered Professional Engineer
1351 West Tapp Road, Bloomington, Indiana 47403
Phone: 812-336-6277 | www.brcj.com
BRCJ Project No.: 11375

Certified by:

ANDREW E. KAUS
REGISTERED PROFESSIONAL ENGINEER
No. 11600092
STATE OF INDIANA
PROFESSIONAL ENGINEER

2025/01/27

100% CONSTRUCTION DOCUMENTS

TEMPLETON ES PLAYGROUND — PHASE 2

Bloomington, IN

SELECTIVE SITE DEMOLITION PLAN

INDIANA 811

Know what's below. Call before you dig. 1-800-382-5544 CALL TOLL FREE PER INDIANA STATE LAW ICB-3-26. IT IS AGAINST THE LAW TO EXCAVATE WITHOUT NOTIFYING THE UNDERGROUND LOCATION SERVICE TWO (2) WORKING DAYS BEFORE COMMENCING WORK.

INDIANA 811

Know what's below. Call before you dig. 1-800-382-5544 CALL TOLL FREE PER INDIANA STATE LAW ICB-3-26. IT IS AGAINST THE LAW TO EXCAVATE WITHOUT NOTIFYING THE UNDERGROUND LOCATION SERVICE TWO (2) WORKING DAYS BEFORE COMMENCING WORK.

Sheet No:
C301

