

MATERIAL LEGEND

- C1.0 Curbing, Refer to Specification 32 13 13
- C1.1 Raised Integral Curb and Walk at Planting Area, Refer to Detail 6/L600
- C1.2 Flush Integral Curb and Walk at Asphalt Play Surface, Refer to Detail 7/L600
- C1.3 Raised Perimeter Nailor Curb, Refer to Detail 5/L600

- F1.0 Site Furnishings, Refer to Specification 32 33 00
- F1.1 Loop Arc Seating, Kompan
- F1.2 Water Fountain, Refer to MEP Plans
- F1.3 Litter Receptacle, Landscape Forms
- F1.4 Sway Bench, Gametime

- F2.0 Playground Features, Refer to Specification 32 33 00
- F2.1 Basketball Goal
- F2.2 Basketball Court Striping, Refer to Detail 6/L604
- F2.3 Hop Scotch Striping, Refer to Detail 4/L604
- F2.4 Four Square Striping, Refer to Detail 5/L604
- F2.5 Painted Obstacle Course

- F3.0 Fencing, Refer to Specification 32 31 19
- F3.1 Ornamental Fence - Type 1: 8'-0" HT, Ameristar Montage Genesis Ornamental Fence with Quad Flare Finial, Black
- F3.2 Ornamental Fence - Type 2: 6'-0" HT, Ameristar Montage Genesis Ornamental Fence with Quad Flare Finial, Black
- F3.3 6'-0" HT, Chain Link Fence, Vinyl Coated, Black
- F3.4 16'-0" Wide Ameristar Montage Genesis, Double Swing Gate
- F3.5 8'-0" Wide Ameristar Montage Genesis, Double Swing Gate

- P1.0 Pavement, Concrete, Refer to Specification 32 13 13
- P1.1 Concrete, 5" with Fiber, Refer to Details 1-2/L600
- P1.2 Concrete, 6" Heavy Duty, with Fiber, Refer to Details 2-3/L600

- P2.0 Pavement, Asphalt, Refer to Specification 32 12 16
- P2.1 Asphalt Play Surface, Refer to Detail 4/L600

- R1.0 Ramp & Wall System, Refer to Specifications 03 30 01, 32 31 19, and 05 50 01
- R1.1 Ramp & Wall System, Refer to Detail 1,7/L604

- S1.0 Stairs and Handrails, Refer to Specifications 03 30 01 and 05 50 01
- S1.1 Stairs, 9 Steps, 3 Tiers, with Handrail, Refer to Detail 3-4/L601 & 1/L604
- S1.2 Stairs, 5 Steps, with Handrail, Refer to Detail 2/L601 & 3/L604

- S2.0 Shade Structures, Refer to Specification 32 33 00
- S2.1 Sky Manta Shade Structure
- S2.2 Sky Ray Shade Structure
- S2.3 Manta Ray Shade Structure - ADD ALTERNATE ITEM

- W1.0 Walls, Refer to Specifications 04 21 14 and 04 43 00
- W1.1 Masonry Pier, Refer to Details 1-3/L602
- W1.2 Brick Veneer and Coping Added to Existing Retaining Wall, Refer to Detail 4/L603
- W1.3 Brick Veneer Retaining Wall with Guardrail, Refer to Detail 8/L600
- W1.4 Masonry Pier Near Entrance, Refer to Detail 1/L603 and 3/L602
- W1.5 Two Sided Brick Veneer Concrete Retaining Wall at Stairs, Refer to Details 5/L603
- W1.6 Narrow Two Sided Brick Veneer Concrete Retaining Wall at stairs, Refer to Details 2-3/L604
- W1.7 Brick Veneer Concrete Seat and Retaining Wall, Refer to Detail 2-3/L603



5825 Lawton Loop E. Dr. | Indianapolis, IN 46216
317-485-6900 | www.context-design.com

100% CONSTRUCTION DOCUMENTS
TEMPLETON ES PLAYGROUND - PHASE 2
Bloomington, IN
Materials and Notes Plan - Phase 2

Revision	Date	Description
1	02-12-2025	Addendum #2

Date: 01/27/2025
Project No: 22-1547
Drawn by: MA / LM
Checked by: JM

These Drawings and Specifications, and all copies thereof are and shall remain the property and copyright of the Landscape Architect. They shall not be used on any other Project or Work without prior written permission from the Landscape Architect.

Sheet No:
L104

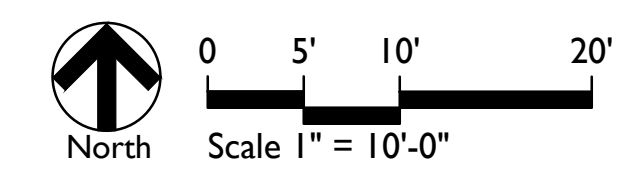

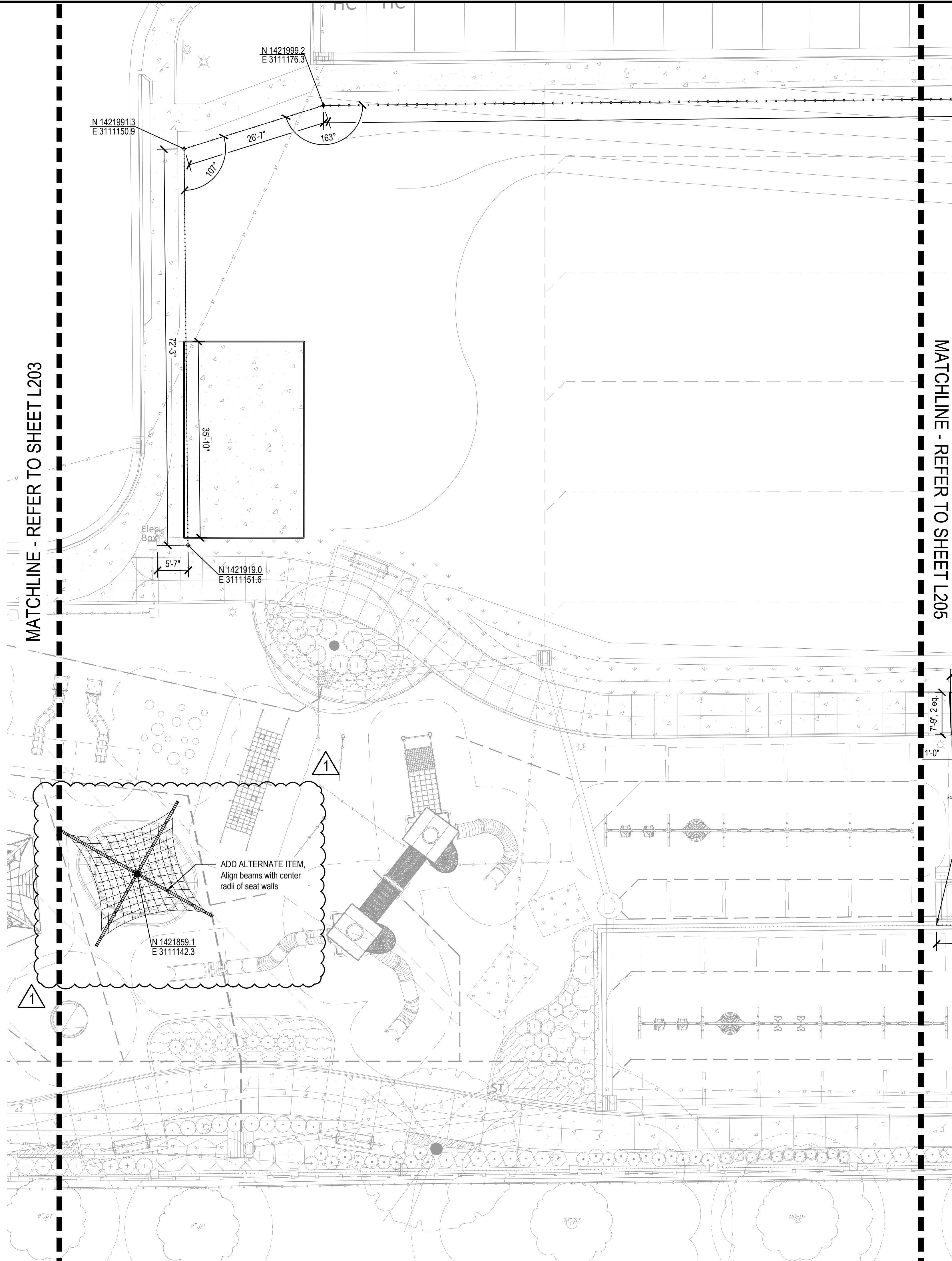

LAYOUT NOTES

1. Dimensions are shown to Face of Curb unless otherwise noted.
2. Contractor shall coordinate final joint locations in the field with the Landscape Architect. Align to existing conditions when practical, including at building and wall corners, connections to existing work, and to centerlines of doors.
3. Space control joints evenly between all bands and expansion joints as shown, unless otherwise dimensioned. Space interim joints equally whenever possible.
4. Digital AutoCAD files will be provided to the successful bidder as a courtesy to assist with field layout. The Contractor maintains all responsibility for the use, accuracy, and confirmation of such data.
5. All pavement striping shown shall adhere to Specifications. The Contractor shall include in their bid any miscellaneous copy, striping, or curb painting that may be requested by the Fire Marshal.
6. All disturbed areas not proposed to receive pavements shall be dressed with topsoil and seeded per Specifications.
7. Contractor shall provide and install One (1) Accessible Parking Sign per accessible parking space indicated in plans. Coordinate final location in the field with Landscape Architect.



100% CONSTRUCTION DOCUMENTS
TEMPLETON ES PLAYGROUND - PHASE 2
 Bloomington, IN
 Layout Plan - Phase 2

Revision	Date	Description
1	02-12-2025	Addendum #2

Date: 01/27/2025
 Project No: 22-1547
 Drawn by: MA / LM
 Checked by: JM

These Drawings and Specifications, and all copies thereof are and shall remain the property and copyright of the Landscape Architect. They shall be used only with respect to this Project and are not to be used on any other Project or Work without prior written permission from the Landscape Architect.

Sheet No:
L204

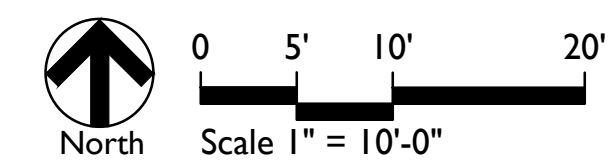

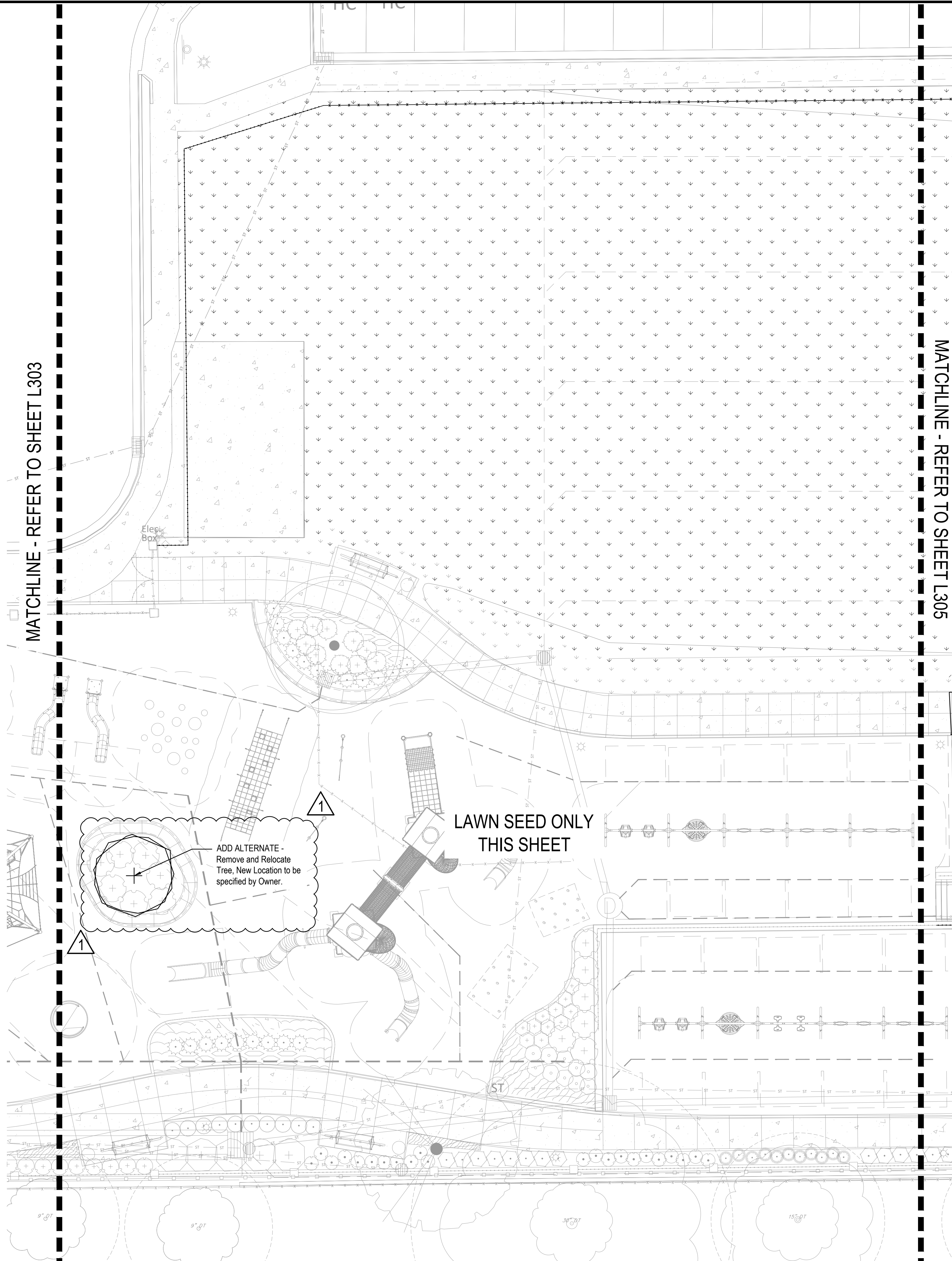

GENERAL LANDSCAPE AND PLANTING NOTES

1. Refer to Project Manual for Planting Specifications and Topsoil requirements. Refer to Plant Schedule and Planting Details for additional information.
2. All materials are subject to the approval of the Landscape Architect and plant bed conditions prior to installation. On-site adjustments may be required.
3. Rootballs shall meet or exceed size standards as set forth in 'American Standards for Nursery Stock'. MAIN LEADERS OF ALL TREES SHALL REMAIN INTACT.
4. Remove from the site any plant material that turns brown or defoliates within five (5) days after planting. Replace immediately with approved, specified material. Plant counts indicated on drawings are for Landscape Architect's use only.
5. Contractor shall make own plant quantity takeoffs using drawings, specifications, and plant schedule requirements (i.e., spacing), unless otherwise directed by Landscape Architect. Contractor to verify bed measurements and install appropriate quantities as governed by plant spacing per schedule. Plant material quantities shown on plan are minimum quantities. Additional material may be needed to meet spacing requirements and field conditions.
6. Seed all areas disturbed by construction activities that are not otherwise noted to receive pavement, planting bed, or sod treatment.
7. The Contractor shall install and/or amend topsoil in all proposed bed areas to meet Specifications. Contractor shall coordinate quantity and placement of topsoil. Landscaper shall verify depth of topsoil prior to plant installation. (Refer to specifications for topsoil source and placement requirements)
8. All tree locations shall be marked with 2x2" stakes prior to planting for review and approval by the Landscape Architect. Any plant material installed in an incorrect location, by the judgment of the Landscape Architect, shall be reinstalled at the Contractor's expense.
9. All plant beds shall receive 3" minimum of shredded hardwood bark mulch (unless otherwise noted).
10. Verify all utility locations in the field prior to beginning work. Repair all damaged utilities to Owner's satisfaction at no additional cost.
11. The Contractor shall maintain all plant material and lawns until the project is fully accepted by the Landscape Architect, unless otherwise noted.
12. All workmanship and materials shall be guaranteed by the Contractor for a period of one calendar year after Final Acceptance.
13. Install all plant material in accordance with all local codes and ordinances. Coordinate with the Owner to obtain any required permits necessary to complete work.
14. Contractor shall test all tree pits for drainage. Any tree pit that holds water for more than 24 hours shall be installed using tree pit drainage.
15. Tree Protection Fencing is the responsibility of the Contractor. Minimum protected area shall include the full drip line of the canopy. NO construction activities, material storage, etc. may occur within that area. The Contractor shall ensure that no soil compaction or tree damage occurs in any Protected areas, at any time during the construction process.
16. Trees shall be matched in groups unless otherwise noted.

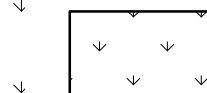
 Area to be Seeded, Refer to Specification 32 92 00



5825 Lawton Loop E. Dr. | Indianapolis, IN 46216
317-485-6900 | www.context-design.com



100% CONSTRUCTION DOCUMENTS

TEMPLETON ES PLAYGROUND - PHASE 2

Bloomington, IN

Planting Plan - Phase 2

Revision	Date	Description
1	02-12-2025	Addendum #2

Date: 01/27/2025
Project No: 22-1547
Drawn by: MA / LM
Checked by: JM

These Drawings and Specifications, and all copies thereof are and shall remain the property and copyright of the Landscape Architect. They shall be used only with respect to this Project and are not to be used on any other Project or Work without prior written permission from the Landscape Architect.

Sheet No:
L304

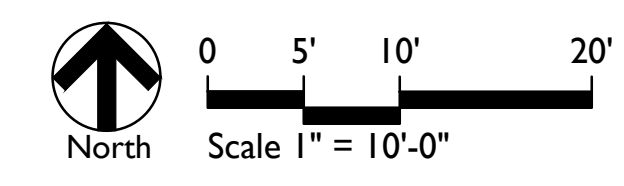

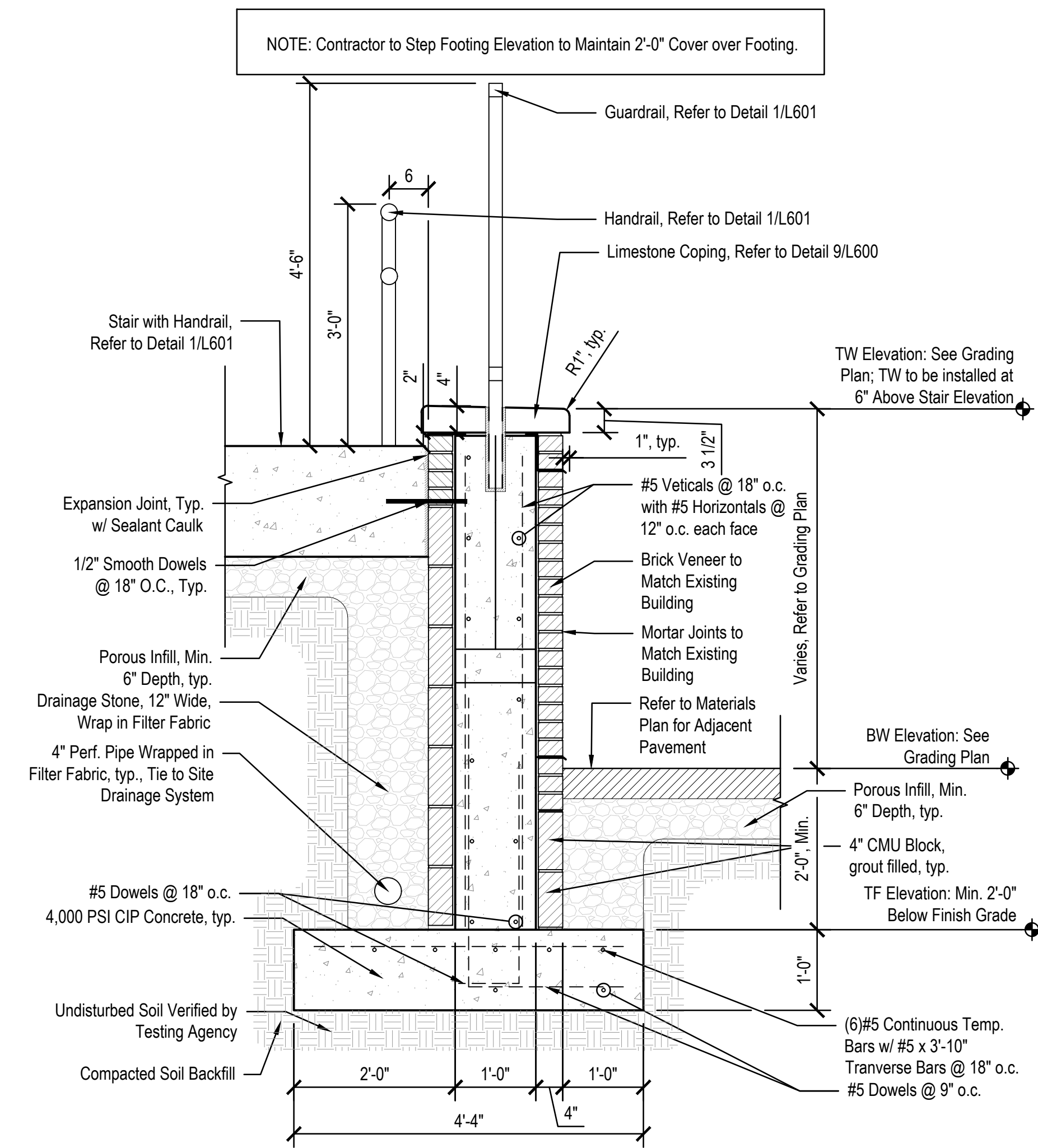

5 TWO SIDED BRICK VENEER RETAINING WALL AT STAIRS

Scale: 3/4" = 1'-0"

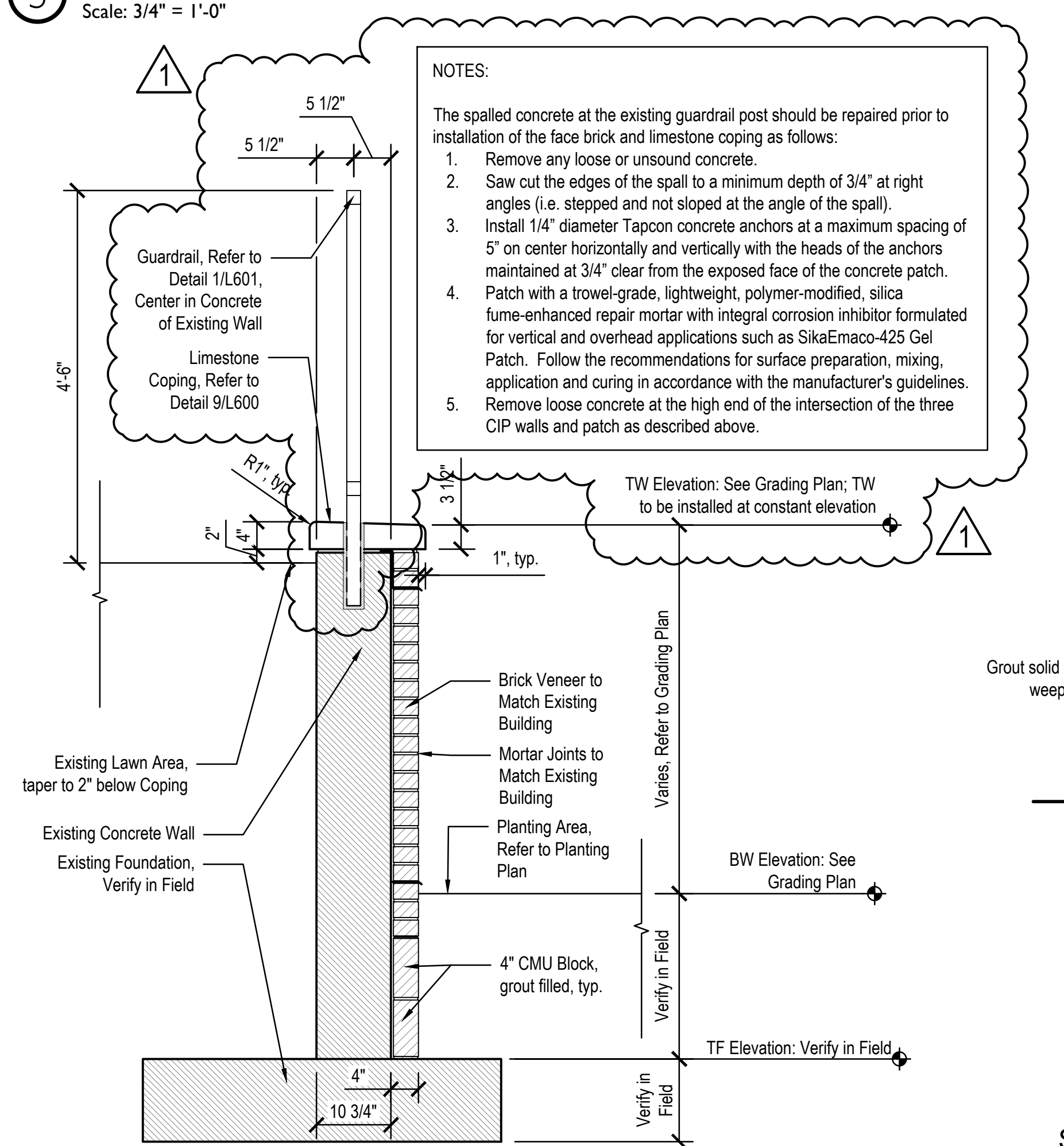

4 BRICK VENEER AND COPING ADDED TO EXISTING WALL

Scale: 3/4" = 1'-0"

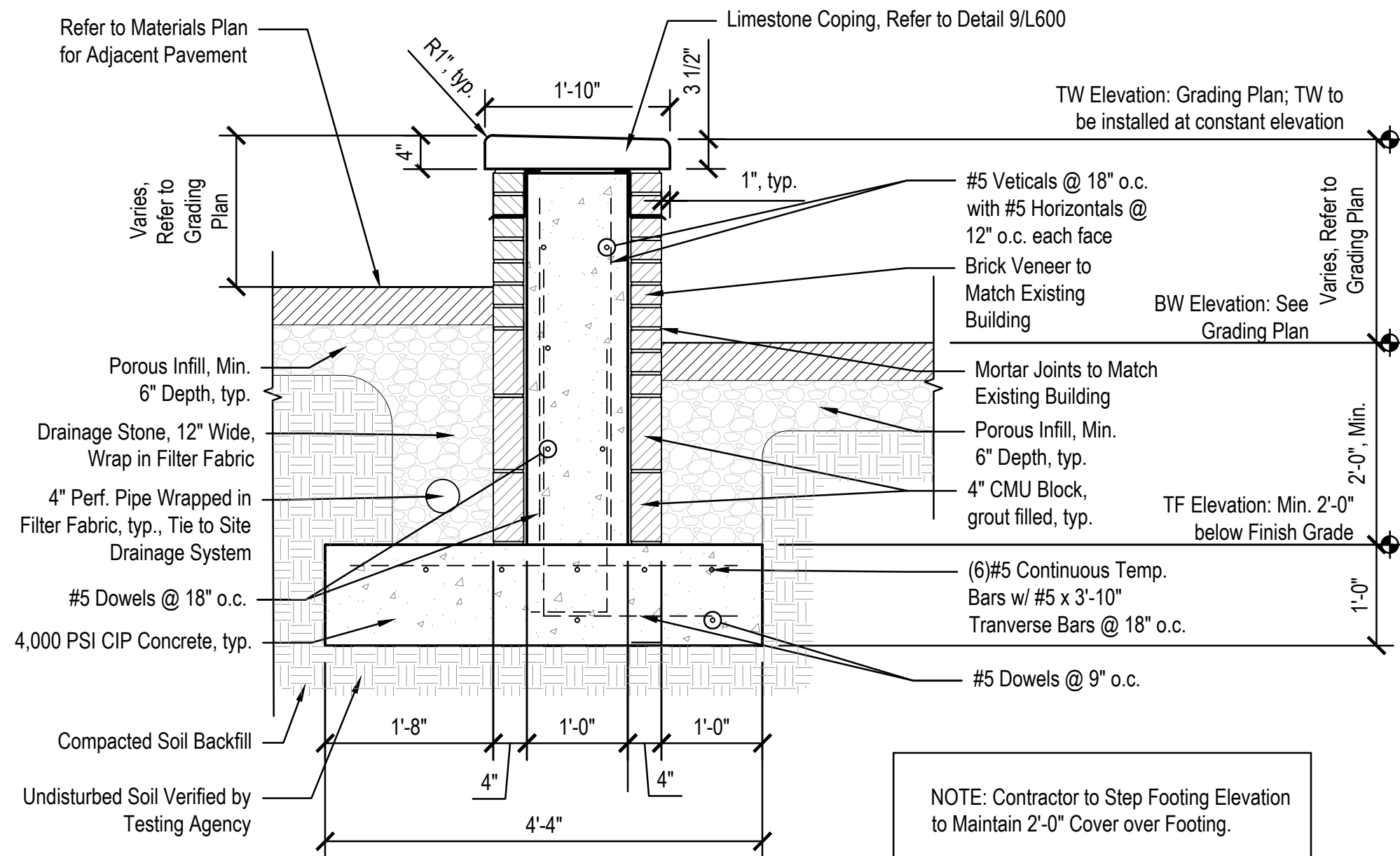

3 BRICK VENEER SEAT AND RETAINING WALL

Scale: 3/4" = 1'-0"

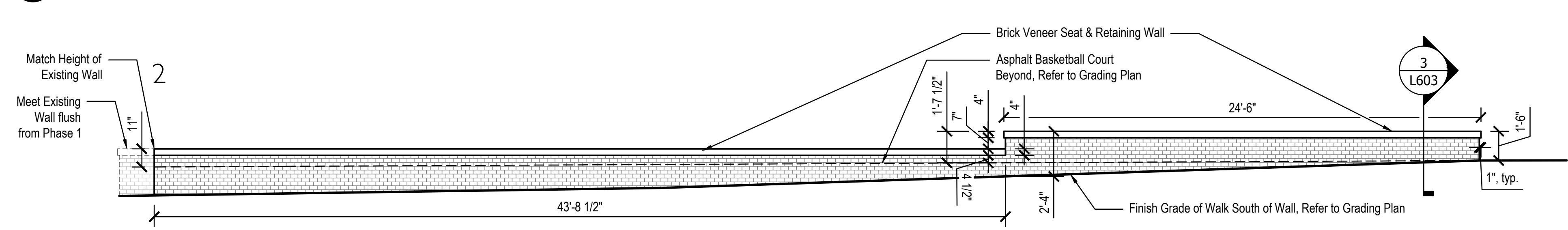

2 SEAT WALL - FLATTENED ELEVATION

Scale: 1/4" = 1'-0"

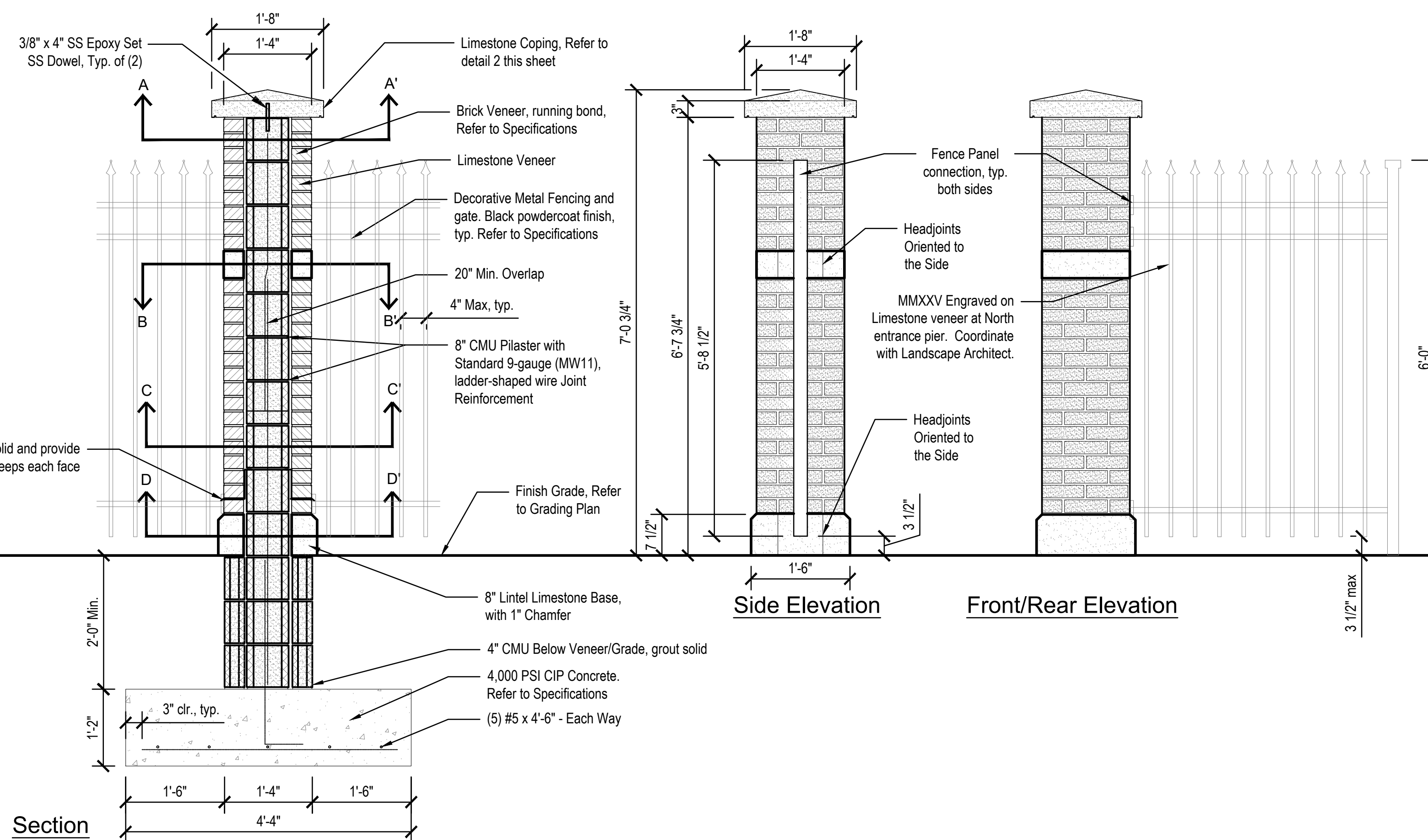

1 MASONRY PIER @ ENTRANCE

Scale: 3/4" = 1'-0"

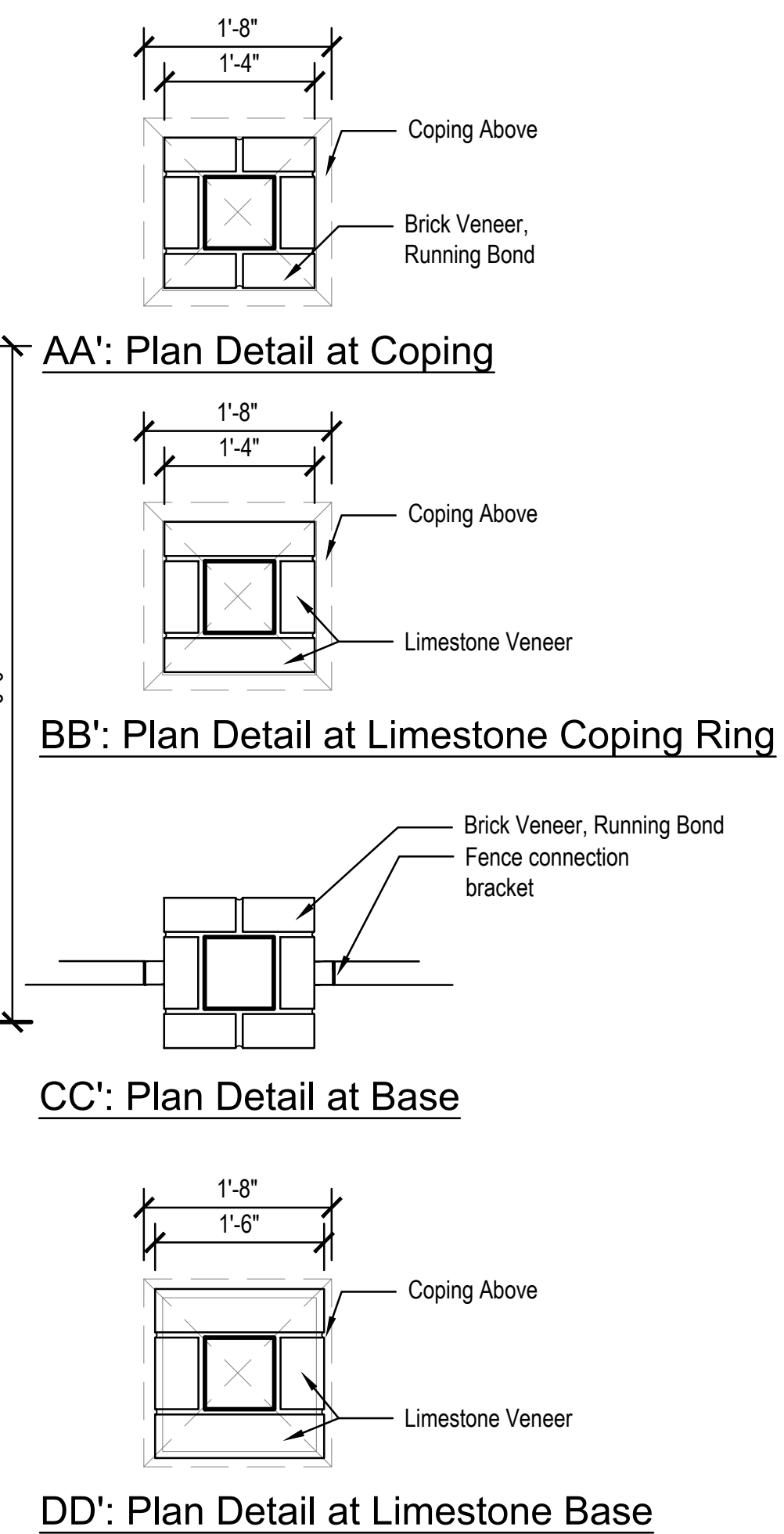

- NOTES:**
- The spalled concrete at the existing guardrail post should be repaired prior to installation of the face brick and limestone coping as follows:
 - Remove any loose or unsound concrete.
 - Saw cut the edges of the spall to a minimum depth of 3/4" at right angles (i.e. stepped and not sloped at the angle of the spall).
 - Install 1/4" diameter Tapcon concrete anchors at a maximum spacing of 5" on center horizontally and vertically with the heads of the anchors maintained at 3/4" clear from the exposed face of the concrete patch.
 - Patch with a trowel-grade, lightweight, polymer-modified, silica fume-enhanced repair mortar with integral corrosion inhibitor formulated for vertical and overhead applications such as SikaEmaco-425 Gel Patch. Follow the recommendations for surface preparation, mixing, application and curing in accordance with the manufacturer's guidelines.
 - Remove loose concrete at the high end of the intersection of the three CIP walls and patch as described above.

Revision	Date	Description
1	02-12-2025	Addendum #2

Date: 01/27/2025
Project No: 22-1547
Drawn by: MA / LM
Checked by: JM

These Drawings and Specifications, and all copies thereof are and shall remain the property and copyright of the Landscape Architect. They shall be used only with respect to this Project and are not to be used on any other Project or Work without prior written permission from the Landscape Architect.